

# KingSlide Sidemount Series

## AD01 - Heavy Duty, Full Extension KingSlide for Wide Cabinets, Large Storage Drawers



### Specifications

**Length:** 10"-40" (250mm-1000mm)  
**Height:** 53 mm (2.09")  
**Side Space:** 19.1 mm (+0.5mm-0mm)  
**Travel:** Full Extension  
**Mount:** Sidemount  
**Load:** 90 kg (200 lb.) Pair  
**Disconnect:** Lever Disconnect  
**Finish:** Clear Zinc Plated or Black  
**Material:** Cold Rolled Steel  
**Packaging:** 6 pairs/carton

### Features

- Heavy Duty Slide with Full Extension Travel
- Heavy Gauge Steel Construction
- Levered Disconnect
- 3/4" (19.1mm) Side Clearance
- 200 lb Dynamic Weight Capacity
- ANSI BIFMA Tested and Certified

### Applications

- Wide Lateral File Drawers
- Large Storage Drawers
- Toolbox

# Full Extension Slide

## Sidemount Slides Series

### Dimensional Specifications

#### Space Requirements

mm (inch)

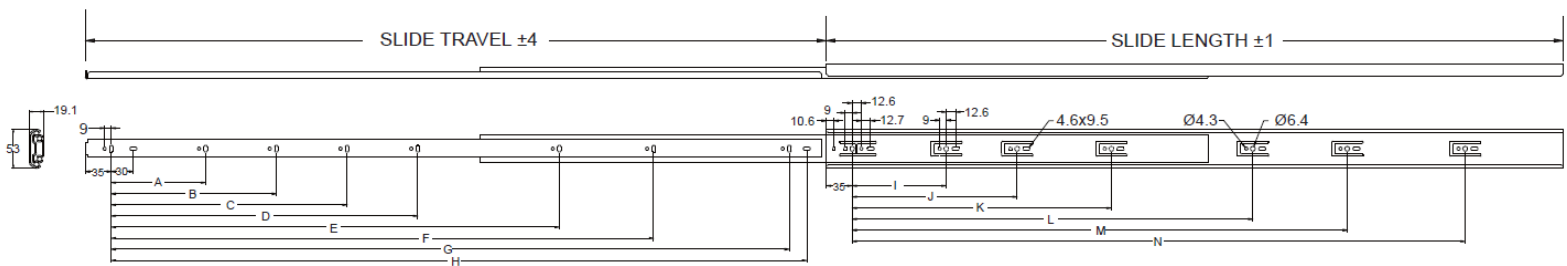
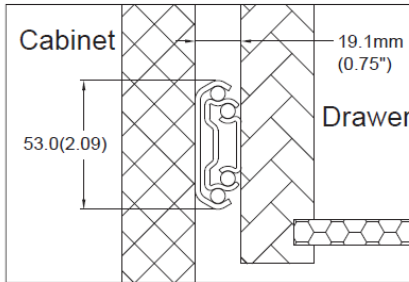

Note: Holes other than those shown are stamped for internal manufacturing purposes and may change without notice.

| Item No.  | Slide Length<br>mm (inch) | Slide Travel<br>mm (inch) | Loading<br>Capacity<br>kg (lb) / pair | Hole Positions mm (inch) |             |             |             |             |             |             |   |            |            |             |             |             |             |
|-----------|---------------------------|---------------------------|---------------------------------------|--------------------------|-------------|-------------|-------------|-------------|-------------|-------------|---|------------|------------|-------------|-------------|-------------|-------------|
|           |                           |                           |                                       | A                        | B           | C           | D           | E           | F           | G           | H | I          | J          | K           | L           | M           | N           |
| AD01-250  | 250.0 (9.84)              | 256.0 (10.07)             | 46.0 (100.0)                          | 96 (3.77)                | —           | —           | —           | —           | —           | —           | — | 181 (7.12) | 160 (6.33) | —           | —           | —           | —           |
| AD01-300  | 300.0 (11.81)             | 306.0 (12.04)             | 54.0 (120.0)                          | 128 (5.04)               | 220 (8.66)  | —           | —           | —           | —           | —           | — | —          | 192 (7.55) | —           | —           | —           | —           |
| AD01-350  | 350.0 (13.78)             | 356.0 (14.01)             | 68.0 (150.0)                          | 128 (5.04)               | 270 (10.63) | —           | —           | —           | —           | —           | — | —          | 224 (8.81) | —           | —           | —           | —           |
| AD01-400  | 400.0 (15.75)             | 406.0 (15.98)             | 80.0 (180.0)                          | 128 (5.04)               | 320 (12.60) | —           | —           | —           | —           | —           | — | —          | 224 (8.81) | 320 (12.59) | —           | —           | —           |
| AD01-450  | 450.0 (17.72)             | 456.0 (17.95)             | 90.0 (200.0)                          | 128 (5.04)               | 320 (12.60) | 370 (14.56) | —           | —           | —           | —           | — | —          | 224 (8.81) | 352 (13.85) | —           | —           | —           |
| AD01-500  | 500.0 (19.69)             | 506.0 (19.92)             | 90.0 (200.0)                          | 128 (5.04)               | 224 (8.82)  | 320 (12.60) | 416 (16.38) | —           | —           | —           | — | —          | 128 (5.03) | 256 (10.07) | 416 (16.37) | —           | —           |
| AD01-550  | 550.0 (21.65)             | 556.0 (21.88)             | 90.0 (200.0)                          | 128 (5.04)               | 224 (8.82)  | 416 (16.38) | 470 (18.50) | —           | —           | —           | — | —          | 128 (5.03) | 352 (13.85) | 448 (17.63) | —           | —           |
| AD01-600  | 600.0 (23.62)             | 606.0 (23.85)             | 90.0 (200.0)                          | 128 (5.04)               | 224 (8.82)  | 416 (16.38) | 520 (20.47) | —           | —           | —           | — | —          | 128 (5.03) | 352 (13.85) | 480 (18.89) | —           | —           |
| AD01-650  | 650.0 (25.59)             | 656.0 (25.85)             | 90.0 (200.0)                          | 128 (5.04)               | 224 (8.82)  | 416 (16.38) | 544 (21.42) | 570 (22.44) | —           | —           | — | —          | 128 (5.03) | 352 (13.85) | 544 (21.41) | —           | —           |
| AD01-700  | 700.0 (27.55)             | 706.0 (27.79)             | 90.0 (200.0)                          | 128 (5.04)               | 224 (8.82)  | 416 (16.38) | 544 (21.42) | 620 (24.41) | —           | —           | — | —          | 128 (5.03) | 224 (8.81)  | 352 (13.85) | 544 (21.41) | —           |
| AD01-750  | 750.0 (29.52)             | 756.0 (29.76)             | 90.0 (200.0)                          | 128 (5.04)               | 224 (8.82)  | 320 (12.60) | 544 (21.42) | 670 (26.38) | —           | —           | — | —          | 128 (5.03) | 224 (8.81)  | 384 (15.11) | 544 (21.41) | —           |
| AD01-800  | 800.0 (31.49)             | 812.0 (31.96)             | 90.0 (200.0)                          | 128 (5.04)               | 224 (8.82)  | 320 (12.60) | 544 (21.42) | 720 (28.35) | —           | —           | — | —          | 128 (5.03) | 224 (8.81)  | 416 (16.37) | 544 (21.41) | 672 (26.45) |
| AD01-850  | 850.0 (33.46)             | 861.0 (33.89)             | 90.0 (200.0)                          | 128 (5.04)               | 224 (8.82)  | 320 (12.60) | 544 (21.42) | 672 (26.45) | 770 (30.31) | —           | — | —          | 128 (5.03) | 224 (8.81)  | 448 (17.63) | 576 (22.67) | 704 (27.71) |
| AD01-900  | 900.0 (35.43)             | 911.0 (35.86)             | 90.0 (200.0)                          | 128 (5.04)               | 224 (8.82)  | 320 (12.60) | 416 (16.37) | 544 (21.41) | 736 (28.97) | 820 (32.28) | — | —          | 128 (5.03) | 224 (8.81)  | 480 (18.89) | 576 (22.67) | 736 (28.97) |
| AD01-950  | 950.0 (37.40)             | 961.0 (37.83)             | 90.0 (200.0)                          | 128 (5.04)               | 224 (8.82)  | 320 (12.60) | 416 (16.37) | 608 (23.93) | 736 (28.97) | 870 (34.25) | — | —          | 128 (5.03) | 224 (8.81)  | 352 (13.85) | 544 (21.41) | 672 (26.45) |
| AD01-1000 | 1000.0 (39.37)            | 1011.0 (39.80)            | 90.0 (200.0)                          | 128 (5.04)               | 224 (8.82)  | 320 (12.60) | 416 (16.37) | 608 (23.93) | 736 (28.97) | 920 (36.22) | — | —          | 128 (5.03) | 224 (8.81)  | 352 (13.85) | 544 (21.41) | 672 (26.45) |

### Ordering

| Item     | Description                                   |
|----------|---|
| 280-1205 | 400mm - AD01 - 200 lb heavy duty ball bearing |
| 280-1206 | 450mm - AD01 - 200 lb heavy duty ball bearing |
| 280-1207 | 500mm - AD01 - 200 lb heavy duty ball bearing |
| 280-1208 | 550mm - AD01 - 200 lb heavy duty ball bearing |
| 280-1209 | 600mm - AD01 - 200 lb heavy duty ball bearing |

### Drawer

